

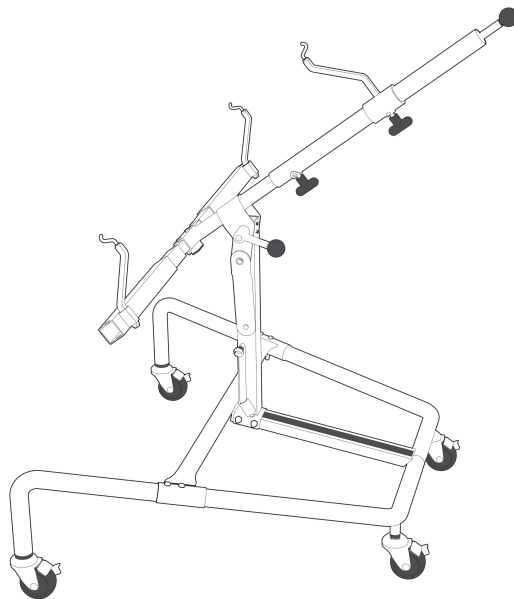

Time-Shaver Tools Inc.



HT10 Panel Thing – Assembly Guide

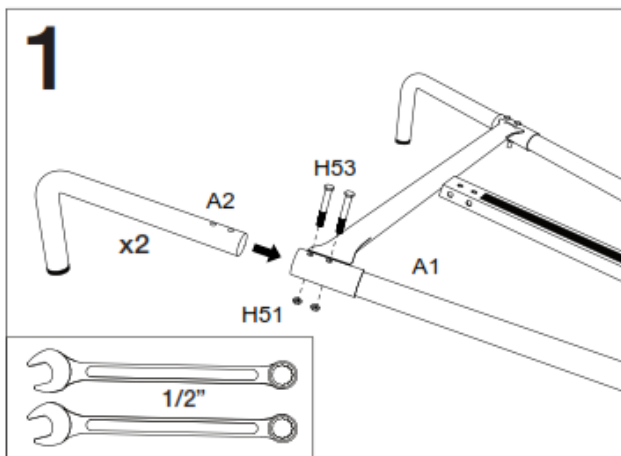

Figure 1: Tap legs (A2) into open ends of base (A1) with dead blow hammer. Attach legs using 5/16" X 2" bolts (H53) and nuts (H51). Tap legs on sides if necessary to make vertical before tightening nuts.

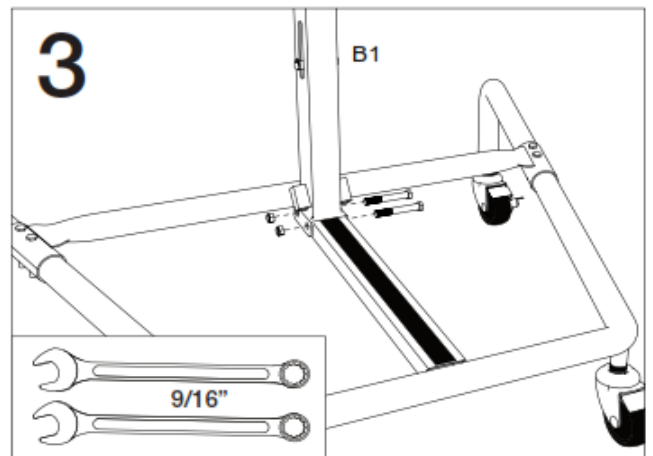

Figure 3 Install upright (B1) using 3/8" X 2-3/4" bolts with nylon insert nuts and tighten with 9/16" wrenches.

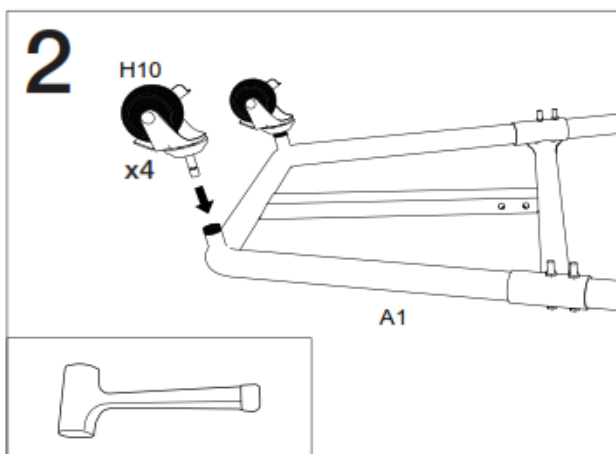

Figure 2: Turn base upside down on floor. Pound swivel casters into sockets using dead blow hammer. Make sure casters stems go in straight to avoid breaking caster sockets.

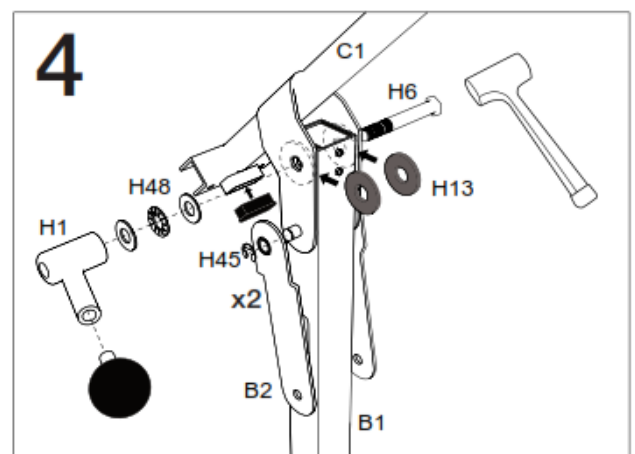

Figure 4 Install pivot assembly (C1) onto upright (B1). Install brown fiber washers (H13) on both sides of upright. Insert 1/2" diameter bolt (H6). Apply a small dab of grease to the thrust bearing (H48) and bolt threads (H6). Place the three-part thrust bearing (H48) onto the H6 bolt before installing the aluminum clamping knob (H1). Slide the flat connecting rods (B2) onto the pins as shown and secure with E-clips (H45).



Time-Shaver Tools Inc.

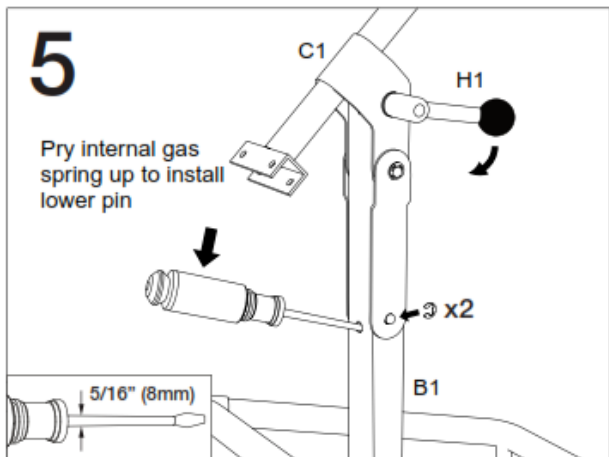

Figure 5 Rotate pivot assembly (C1) to 45 degrees from vertical. Tighten clamping knob (H1). Remove one E-clip from the lower pin (which is pre-installed in the upright). Insert a large blade screwdriver into the hole in the upright (B1). Push down on the screwdriver to pry up the gas spring inside. While holding the gas spring up, slide the pin out. Pry the gas spring up again and re-install the pin through the connecting rods (B2) and the gas spring end fitting. Install the E-clip (H45) back onto the lower round pin.

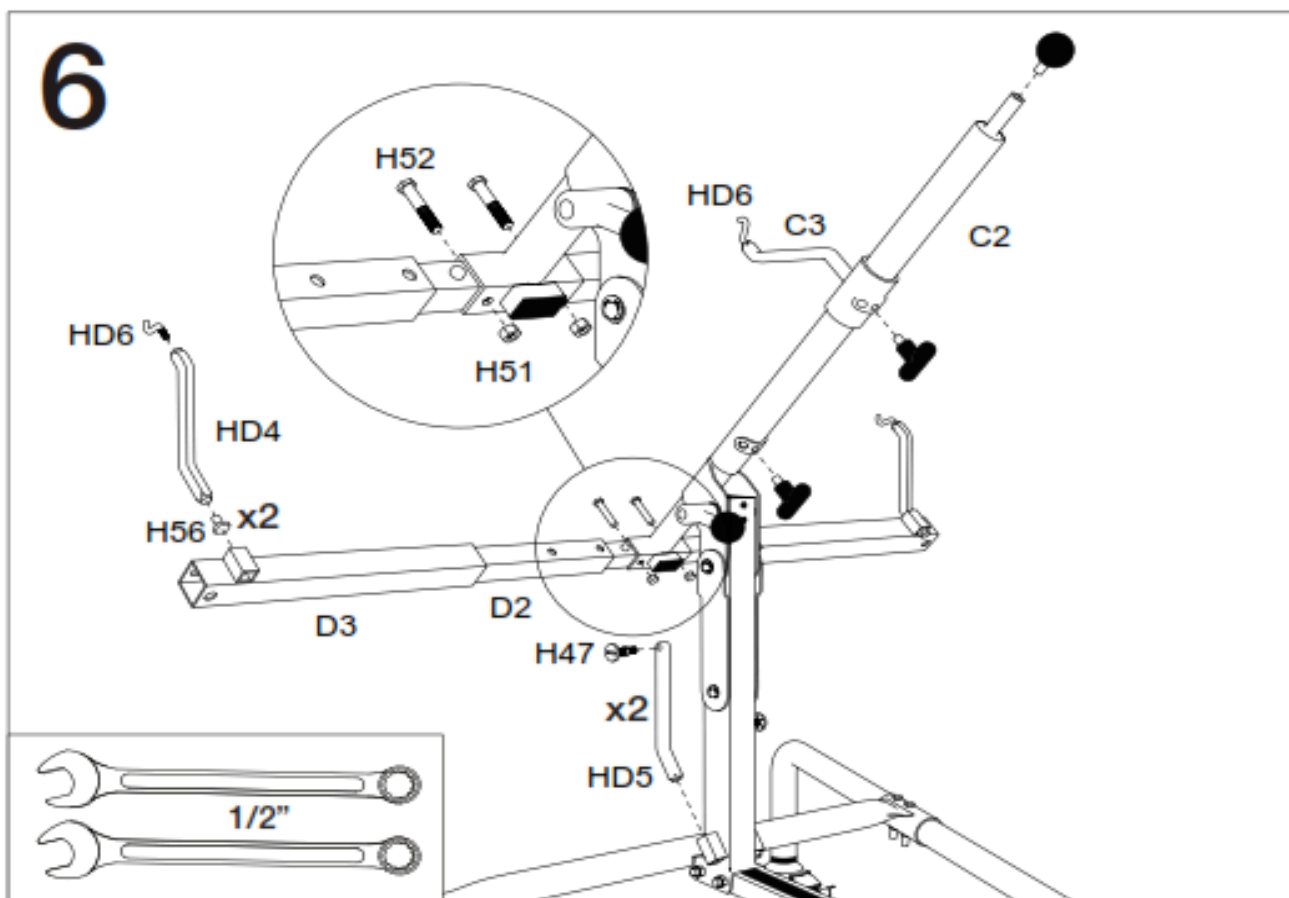

Figure 6 Attach T-bar (D1) onto pivot bracket (C1) using 5/16"X1-3/4" bolts (H52) and nylon insert nuts (H51). The D1 T-bar and C1 Pivot Bracket may be seen on the Parts Guide drawing. Note that the push buttons on the T-bar (D1) point upward. Tighten nuts (H51) with 1/2" wrenches. Install tailgate bolts (H47) with lock nuts onto tailgate adapter arms (HD5). Install square sliders (D2, D3) onto T-bar as shown. Install round sliders (C2, C3) onto round tube of pivot bracket (C1). Slide the parts adaptor arms (HD4) into the D3 sliders as shown pointing upward for holding most body panels. The parts adaptor arms (HD4) may be installed horizontal or downward to bring larger hoods into balance. Install T-knobs, ball knobs and tube plugs as shown. Always use tailgate arms (HD5) in the upward pointing direction.